

## Linear Park

Linear Park is a wildlife conservation area with ponds, woodland, scrubland and reedbed. It follows part of an old railway line, starting at the old Russpidge Halt railway station which is now the car park and borders the town of Cinderford to the east.

Please note: Parts of the path are shared with cyclists.

### About the route

- This is a short, flat route which takes in a small part of a much longer walk around Linear Park
- There are several benches as marked on the map

### Accessibility

- A new path surface has recently been laid (January 2025) making it easier for those who find walking difficult
- The route is wheelchair accessible
- There are two short slopes as indicated on the map

The artwork shown in boxes 1-8 was created by attendees of one of our recent walks. The artwork is by Dan, Rachel, Tom, Clancy and Jenny.

### The art materials used include

- Paper / pad
- Wax crayon
- Ink
- Charcoal
- Camera

### What the numbers on the map refer to

1. Reflections on water
2. Tree trunk
3. Ducks
4. Woodgrain rubbings
5. Tree stump/bird table
6. View through the trees
7. Scots Pine tree
8. Small Oak tree



## About Canopy Creative Network

Canopy Creative Network was formed in 2017 to bring artists, arts organisations and communities in the Forest of Dean together. We run festivals, walks, talks, workshops and a range of other events.

Find out more at [www.canopynetwork.co.uk](http://www.canopynetwork.co.uk)

### Canopy Creative Walks

Since 2020 we've run creative walks for small groups across the forest of Dean. Open to all, the routes are short with a range of creative activities along the way guided by a local artist. A notebook and art materials are provided and we only ask for donations to cover the costs. You can see some of the work produced on our creative walks in the boxes alongside this map.

### Why walking in nature is so important

- Reduces stress
- Improves your mood, sleep and concentration
- Boosts your immune system
- Provides vitamin D
- Socialise and meet new people

### How to enjoy this walk safely

- Please wear sturdy footwear and clothing appropriate for the weather
- This is a working forest, so adhere to any safety information displayed
- Please don't feed or approach wild animals
- Please only park in designated bays and not on verges

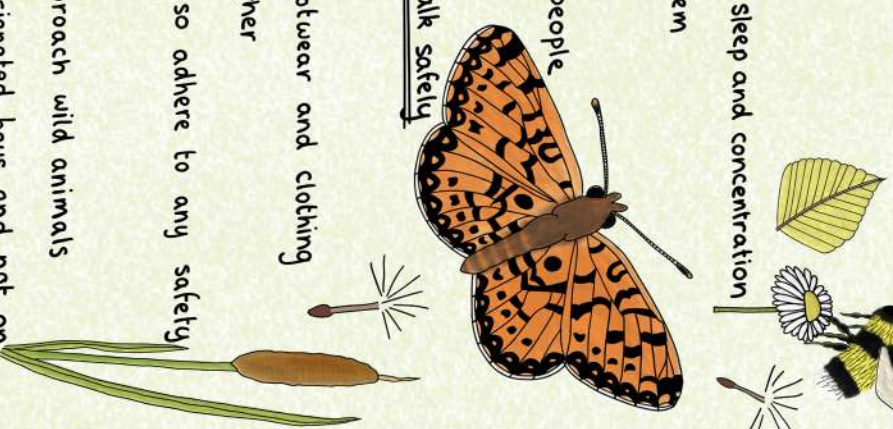

# Linear Park Creative Walk Map

## Linear Park Creative Walk Map



Free parking - Car park address:

Russpidge Hall, St Whites Rd, Russpidge, Cinderford, Gloucestershire GL14 3ER

What 3Words - brudges.vented.proudest  
Length of walk - 0.8 miles / 1.29 km

Produced by Canopy Creative Network  
[www.canopynetwork.co.uk](http://www.canopynetwork.co.uk) printed on recycled paper

We hope this map inspires you to enjoy a short walk in the Forest of Dean.

Maps illustrated by Becky Embling

All of our creative walk maps are available to download on our website



"Nurturing connection, creative thinking and mental wellbeing through a combination of lime outdoors, gentle exercise and social interaction."

"Thank you for a lovely walk and getting me out in nature."

"Helped reignite my love for art."



N  
↑

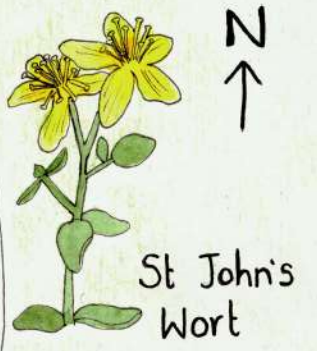

St John's Wort

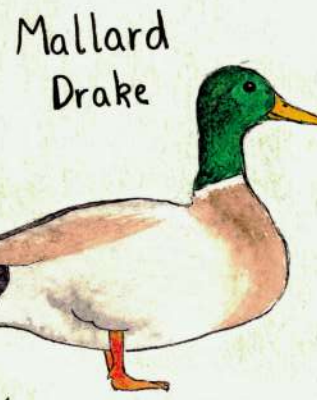

Mallard Drake

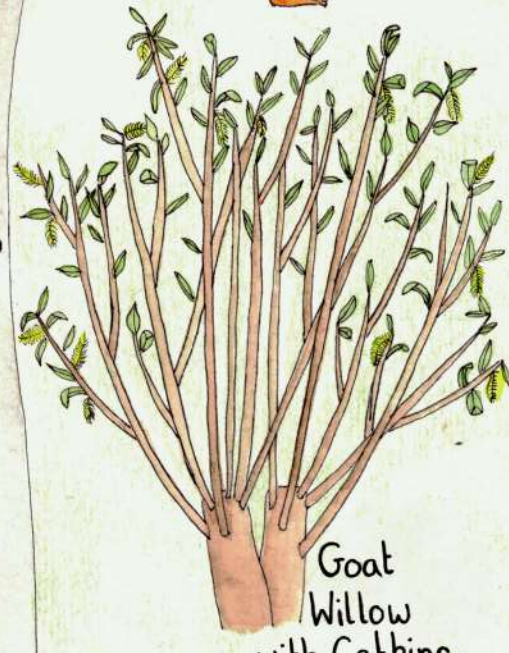

Goat Willow with Catkins



Dingy Skipper

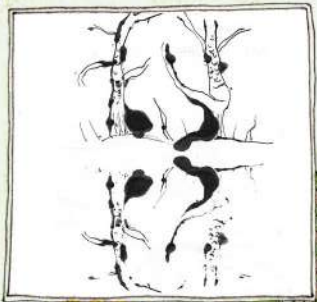

1



Poplar Trees

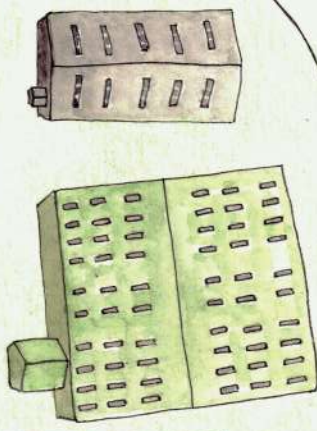

Moorhen



3

Creeping Thistle



Grey Heron

Great Reedmace

Butterfly Habitat

5



Burdock

2

Cow Parsley



Dandelion

8



Oak Tree



European Toad



Goat Willow

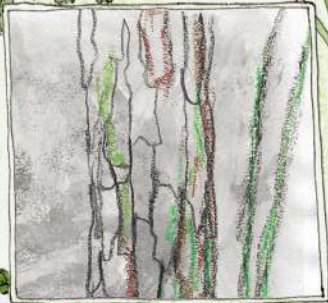

Black Hawthorn

7



Common Inkcap



Buff-tailed Bumblebee



Small Pearl-bordered Fritillary



Start / Finish

Ruspidge Halt Car Park

bus stop



St White's Road

Speech House Road

# Linear Park Creative Walk Map

▲ - Steep Incline  
| | 1cm = 18.4 metres

Route Distance - 0.80 miles

See key on other side



Grizzled Skipper